

NOTE
 This drawing must not be reissued, loaned or copied without the written consent of NPS South East Ltd. (the originator).
 All errors, omissions, discrepancies should be reported to the originator immediately. All dimensions to be checked before site fabrication by the contractor, his sub-contractor or supplier.
 Do not scale plans - use figure or grid dimensions where given.
 Any deviation from the drawing to be reported to the originator immediately.

Any mapped information depicted is based on Ordnance Survey material with the permission of Ordnance Survey on behalf of the Controller of Her Majestys Stationary Office Crown Copyright.
 Unauthorized reproduction infringes Crown Copyright and may lead to prosecution or civil proceedings.
 Norfolk County Council License No: LA 100019340 dated 2009
 Ref: TG

Drawing issue status:
 PRELIMINARY CLIENT APPROVAL PLANNING
 BUILDING REGS TENDER CONSTRUCTION AS-BUILT

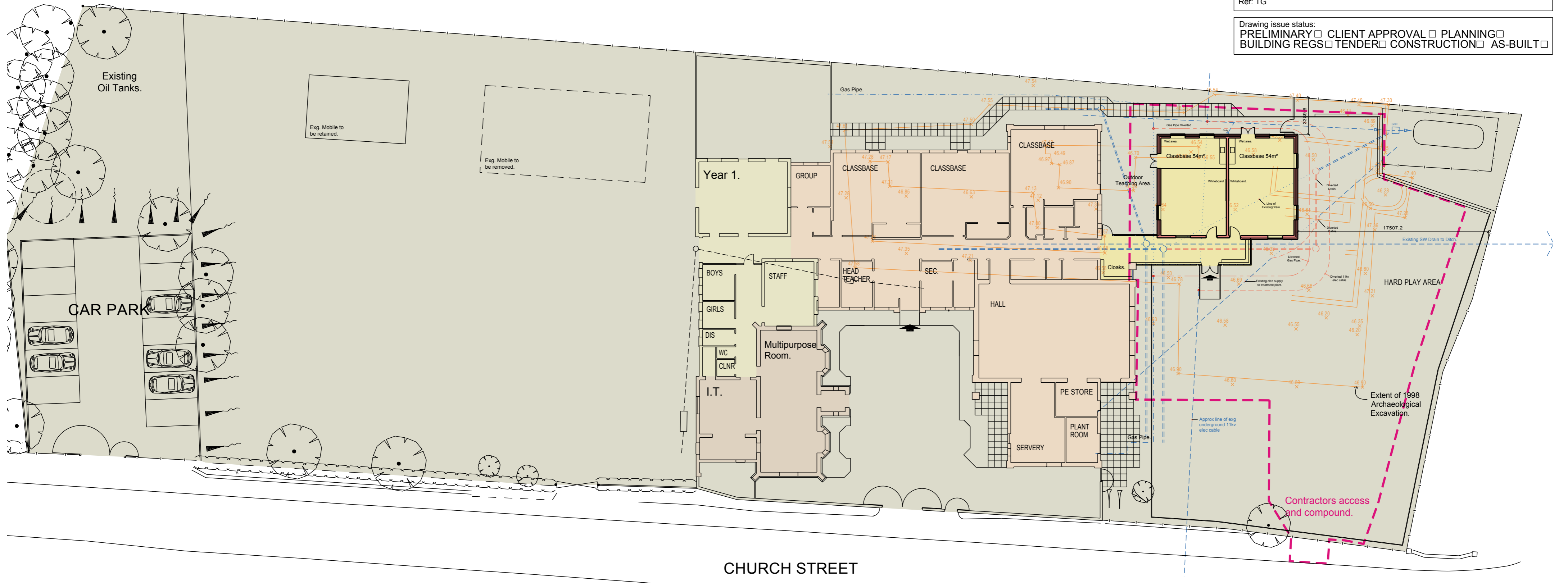
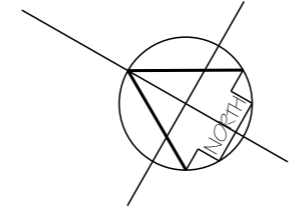

Site Plan 1:250.

- Original 1846 School.
- 1992 Extension.
- 1998 Extension.
- Proposed Extension.

REV	DATE	DESCRIPTION
NPS SOUTH EAST LTD		
<input type="checkbox"/> NORWICH OFFICE NAUTILUS HOUSE NRT OHR TEL: 01603 706706 FAX: 01603 706700 <input type="checkbox"/> CHELMSFORD OFFICE CM2 0JA TEL: 01245-505400 FAX: 01245-505401 <input type="checkbox"/> NEEDHAM MARKET OFFICE IP6 8AS TEL: 01449-727670 FAX: 01449-727696 <input type="checkbox"/> BRIGHTON OFFICE BN2 6NT TEL: 01273 391100 FAX: 01273 391101 <input type="checkbox"/> HAMPTON COURT OFFICE KT8 9HD TEL: 020 8481 7920 FAX: 020 8481 7921 <input type="checkbox"/> WHITSTABLE OFFICE CT5 2QJ TEL: 01227 793480 FAX: 01227 793605 <input type="checkbox"/> LUTON OFFICE LU1 1QZ TEL: 01582 544710 FAX: 01582 728662		
PROJECT Proposed Extension to Carbrooke VC Primary School		CLIENT Director of Education NCC.
SUBJECT Proposals Site Plan		DATABASE DATE SCALE Feb 2010 1:200
PROJECT NR CD 10301	DRAWING NR 01	REV DRAWN CHECKED